

Department of Engineering  
Tim Bryan, P.E., PTOE, County Engineer

3137 South Liberty Street, Canton, MS 39046  
Office (601) 855-5582 FAX (601) 859-5857

**MEMORANDUM**

October 11, 2024

To: Casey Brannon, Supervisor, District I  
Trey Baxter, Supervisor, District II  
Gerald Steen, Supervisor, District III  
Karl Banks, Supervisor, District IV  
Paul Griffin, Supervisor, District V

From: Tim Bryan, P.E., PTOE  
County Engineer

Re: Atmos Energy Corporation Utility Permit  
County Road Name, Robinson Springs Road

The Engineering Department recommends approval of the permit application for Atmos Energy to install approximately 8,290' of 4" HDPE main to service nineteen potential customers near Robinson Springs Road.

Revised: 2/14/2019



## PERMIT APPLICATION FOR THE CONSTRUCTION OR ADJUSTMENT OF A UTILITY WITHIN COUNTY ROAD RIGHT-OF-WAY

Utility Information: Utility Name: Atmos Energy Corp.

Address: 2305 Lakeland Drive City/State/Zip: Flowood/MS/39232

Contact Person: John Stowers Contact's Phone: (601) 665-5160

Project Information: County Road Name: Robinson Springs Road

*(If located within more than one road right-of-way, use Appendix 1 for additional descriptions)*

Beginning Location: 50' E of Coker Rd and Robison Springs Rd Intersection Ending Location: 50' W of Deer Haven Dr. and Robinson Springs Rd. Intersection

Length of Project: 8,290 feet Section: 4 & 32 Township: 7 & 8 Range: 1E

Description of Work: Install approximately 8,290' of 4" HDPE main to serve nineteen potential customers near Robinson Springs Road.

Check Box if Appendix 1 is to be included as a part of this Application

Whereas the above stated Utility makes application to the **Madison County Board of Supervisors** for a Construction Permit. Attached hereto are drawings and plans for the construction of the above facilities located within Madison County owned public rights-of-way. Once stamped by the Madison County Engineering Department, these plans shall not be changed or altered without written approval of the County Engineer, or his representative. A copy of the approved permit and plans shall be on-site at all times during construction.

The Applicant Utility shall comply with all policies, procedures and construction practices as outlined in *A Policy for The Accommodation of Utility Facilities within the Right-of-Way of all Public County Roads* (hereinafter referred to as the "Policy"), as adopted on November 1, 2005, by the **Madison County Board of Supervisors**, and which is hereby made a part of this Application Agreement.

If facilities are to be located within the Rights-of-Way of the County-Federal or State Aid System, Applicant Utility also agrees to comply with applicable provisions of *S.O.P. No. SA II-2-8, Accommodation of Utilities on Rights-of-Way*, issued by the State Aid Engineer and dated July 1, 2005.

The Applicant Utility understands and agrees that, except as herein granted, no right, title, claim, or easement to said road right-of-way is granted by the issuance of this permit. If this Utility is listed in the general provisions of the Policy, it will be adjusted to comply with same without cost to the County, unless the variance from the Policy has been approved by the granting of the Permit pursuant to this Application.

The Applicant Utility further understands that the Utility's engineering, plant, or other personnel will be responsible for the staking and construction supervision of the work set out above and as shown on the attached plans. **If work impacts traffic in any way, the appropriate traffic control shall be installed per the *Manual of Uniform Traffic Control Devices*, Latest Edition.**

The Applicant Utility understands that the County Engineer, or his representative, may issue a Stop Work Order at any time if it is deemed that site conditions are not suitable for construction or if any of the requirements of this permit are not being met.

Many County Roads have variable Rights-of-Way and/or no Right-of-Way at all and are maintained under a Prescriptive Easement. It is the sole responsibility of the Applicant Utility to verify the existence and limits of public rights-of-way. If none exists, it is the

responsibility of the Applicant Utility to acquire an easement for their Facilities from the applicable property owner(s). Madison County in no way verifies the limits of Right-of-Way as shown on the permit application.

The Applicant Utility shall be responsible for all future maintenance and repair of the facilities installed under this permit. The Applicant Utility shall make future adjustments to, or relocate, the facilities located within road or highway right-of-way when required for road or highway widening or other road or highway construction at no cost to Madison County. The Applicant Utility shall relocate said utilities within sixty (60) days of notification by County by registered mail, return receipt requested, unless otherwise designated by the County Engineer. Further, any maintenance, repair, or construction shall be done in such a manner as to occasion no unreasonable interference with the normal flow and safety to traffic and at the expense of the utility company. When reasonable care has been taken to locate said utility facilities within the right-of-way, the Applicant Utility understands that any damages caused by routine maintenance and construction by County forces shall be borne by the Applicant Utility.

The Applicant Utility further agrees to indemnify and hold Madison County harmless for any and all claims, accidents, damages, liabilities and expenses occasioned wholly, or in part, by any act or omission of applicant, its agents or employees. In case County shall, without fault on its own part, be made a party to any litigation commenced by or against applicant, then applicant shall protect and hold County harmless, and shall pay all costs, expenses and reasonable attorney's fees incurred or paid by County in connection with said litigation.

All underground facilities shall be installed at a depth equal to or greater than 48" below the lowest adjacent grade.

All pipes carrying liquid shall be encased under County maintained roads.

WITNESS the signature of the Applicant this the 11th day of October, 2024.

By: John Stowers  
(Applicant Signature)

Title: Engineer 2

**Note:** Applicant must be an employee of the Utility named in this application. The Madison County Board of Supervisors will not recognize a Contractor, Subcontractor, Agent, or Consulting Engineer as the Applicant. Utility Company shall be fully responsible for all work performed under this application.

I, or my authorized representative, have reviewed this application and determined that the drawing, sketches, and plans submitted by the Applicant meet the requirements of A Policy for The Accommodation of Utility Facilities within the Right-of-Way of all Public County Roads.

**APPROVED**  
By: **By timothy.bryan at 8:21 am, Oct 31, 2024**  
Tim Bryan, P.E.  
County Engineer

AGREED TO AND APPROVED BY:

\_\_\_\_\_  
Madison County Board President

Date: \_\_\_\_\_

ENTERED INTO THE MINUTES OF THE BOARD OF SUPERVISORS OF MADISON COUNTY, MISSISSIPPI ON THIS

\_\_\_\_\_ DAY OF \_\_\_\_\_, 20\_\_\_\_\_.

ROBINSON SPRINGS ROAD - MADISON  
 MADISON, MADISON COUNTY, MISSISSIPPI  
 070.53923

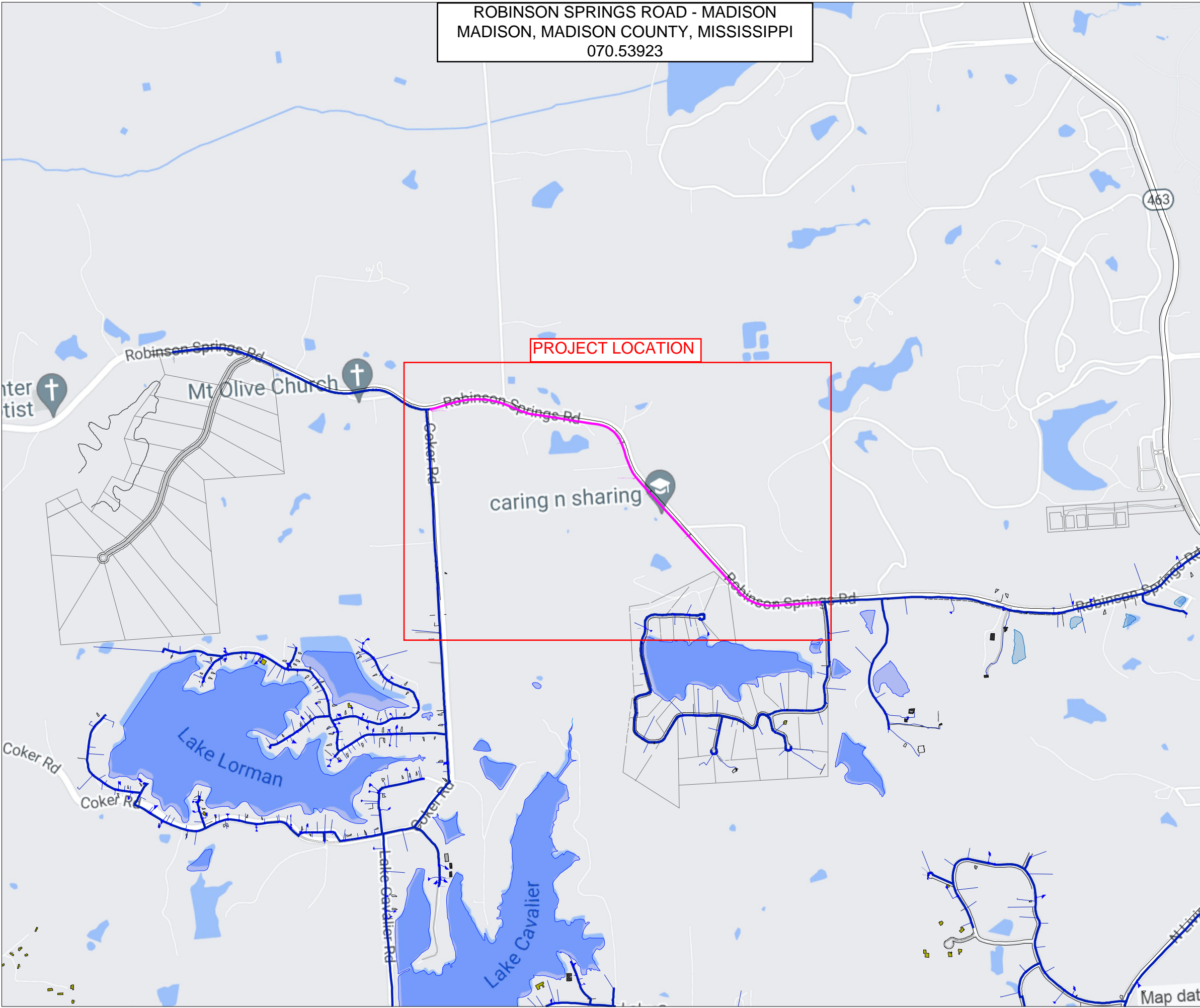

- NOTES:
- MAOP 60 PSIG.
  - MAIN TO BE INSTALLED AT **4FT** MIN. COVER UNLESS OTHERWISE SPECIFIED.
  - TEST ALL MAIN AT 150 PSIG FOR 8 HOURS.
  - SEWER MAIN AND LATERALS MUST BE SPOTTED DURING INSTALLATION OF MAIN BY TRENCHLESS MEANS.
  - TRACER WIRE (#8) TO BE INSTALLED 6" ABOVE ALL HDPE GAS MAIN INSTALLED BY OPEN TRENCH.
  - TRACER WIRE (#8, ONE STRAND) TO BE INSTALLED WITH ALL HDPE MAIN INSTALLED BY TRENCHLESS MEANS.
  - PIPELINE WARNING TAPE TO BE INSTALLED AT 12" ABOVE ALL GAS MAIN INSTALLED BY OPEN TRENCH.
  - MARKER BALLS ARE TO BE INSTALLED AT ALL VALVES AND END OF MAIN LOCATIONS.



**GAS CONSTRUCTION PRINT**

PROJECT NO. 070.53923



SHEET 1 OF 11

PROJECT Stowers, John  
 MANAGER

DATE 09/03/2024

100

PHONE

MAP #

© 2009 Atmos Energy

Maps, drawings and electronic data (products) are created for the internal purposes of Atmos Energy with no implication of suitability or fitness for the internal use of the recipient. Atmos Energy will make good faith efforts to provide products that are free from error, but does not warrant the accuracy or quality of such products. The locations shown are approximations and are not intended to show exact locations. Products provided to other parties by Atmos Energy are for the internal use of the recipient, and the recipient agrees not to duplicate or distribute the products or any portion of the products to third parties without the prior written permission of Atmos Energy. The recipient further agrees to hold harmless and indemnify Atmos Energy against all claims, costs, expenses and damages resulting from or predicated upon strict liability for personal injuries, death or property damage, on account of any defects in the property provided hereunder.

PROJECT NAME 070.5073.RG.4PE.ROBSPRING.PH2

CUSTOMER

ADDRESS

LOCATION MADISON, MS

Map data

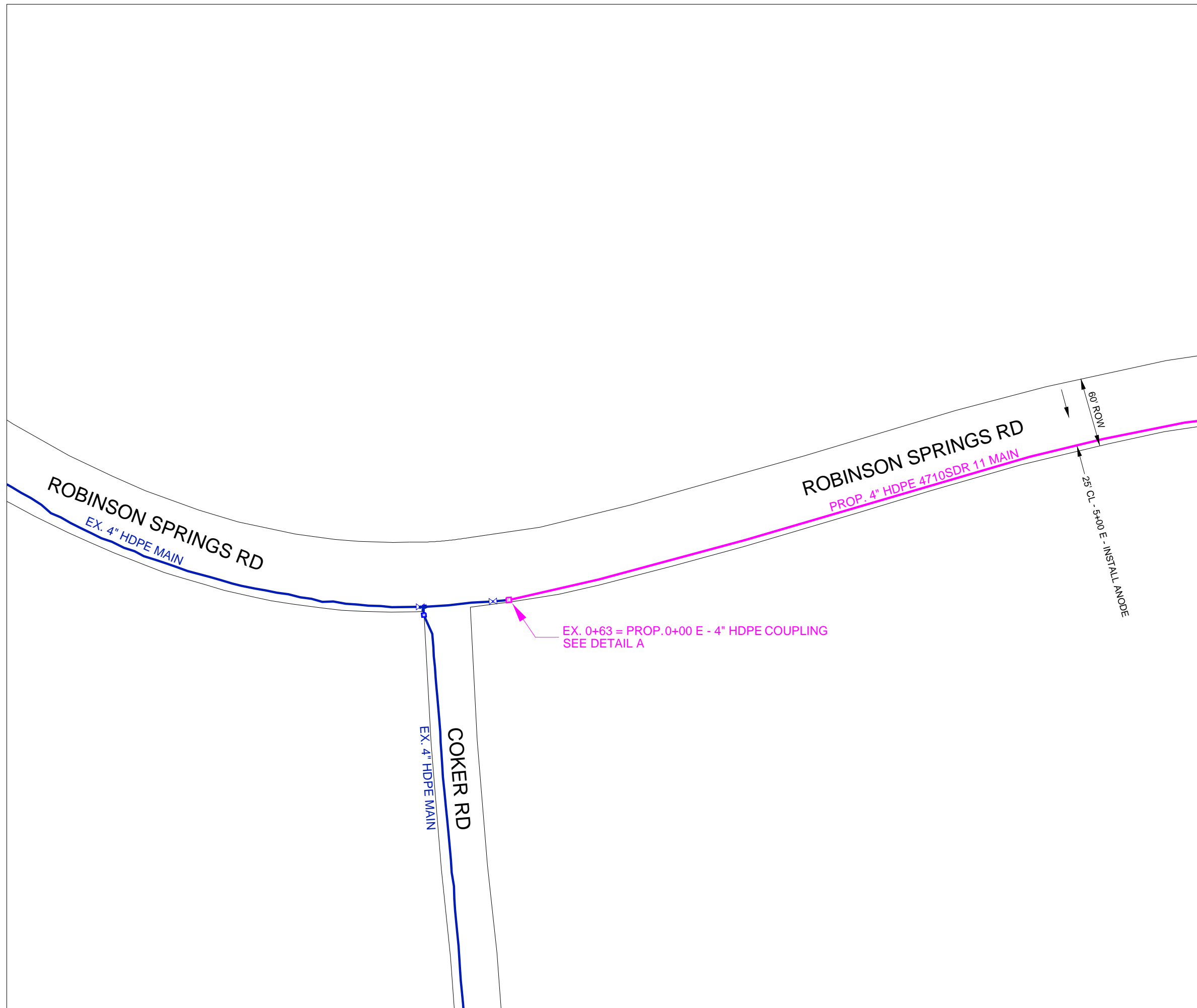

- NOTES:
- MAOP 60 PSIG.
  - MAIN TO BE INSTALLED AT **4 FT** MIN. COVER UNLESS OTHERWISE SPECIFIED.
  - TEST ALL MAIN AT 150 PSIG FOR 8 HOURS.
  - SEWER MAIN AND LATERALS MUST BE SPOTTED DURING INSTALLATION OF MAIN BY TRENCHLESS MEANS.
  - TRACER WIRE (#8) TO BE INSTALLED 6" ABOVE ALL HDPE GAS MAIN INSTALLED BY OPEN TRENCH.
  - TRACER WIRE (#8, ONE STRAND) TO BE INSTALLED WITH ALL HDPE MAIN INSTALLED BY TRENCHLESS MEANS.
  - PIPELINE WARNING TAPE TO BE INSTALLED AT 12" ABOVE ALL GAS MAIN INSTALLED BY OPEN TRENCH.
  - MARKER BALLS ARE TO BE INSTALLED AT ALL VALVES AND END OF MAIN LOCATIONS.

**ATMOS energy** **GAS CONSTRUCTION PRINT**

PROJECT NO. 070.53923

SHEET 2 OF 11

DATE 09/03/2024

PROJECT Stowers, John  
MANAGER \_\_\_\_\_ 100

PHONE \_\_\_\_\_ MAP # \_\_\_\_\_

© 2009 Atmos Energy

Maps, drawings and electronic data (products) are created for the internal purposes of Atmos Energy with an implication of suitability or fitness for the internal use of the recipient. Atmos Energy will make good faith efforts to provide products that are free from error, but does not warrant the accuracy or quality of such products. The locations shown are approximations and are not intended to show exact locations. Products provided to other parties by Atmos Energy are for the internal use of the recipient, and the recipient agrees not to duplicate or distribute the products or any portion of the products to third parties without the prior written permission of Atmos Energy. The recipient further agrees to hold harmless and indemnify Atmos Energy against all claims, costs, expenses and damages resulting from or predicated upon strict liability for personal injuries, death or property damage, on account of any defects in the property provided hereunder.

PROJECT NAME 070.5073.RG.4PE.ROBSPRING.PH2

CUSTOMER \_\_\_\_\_

ADDRESS \_\_\_\_\_

LOCATION MADISON, MS

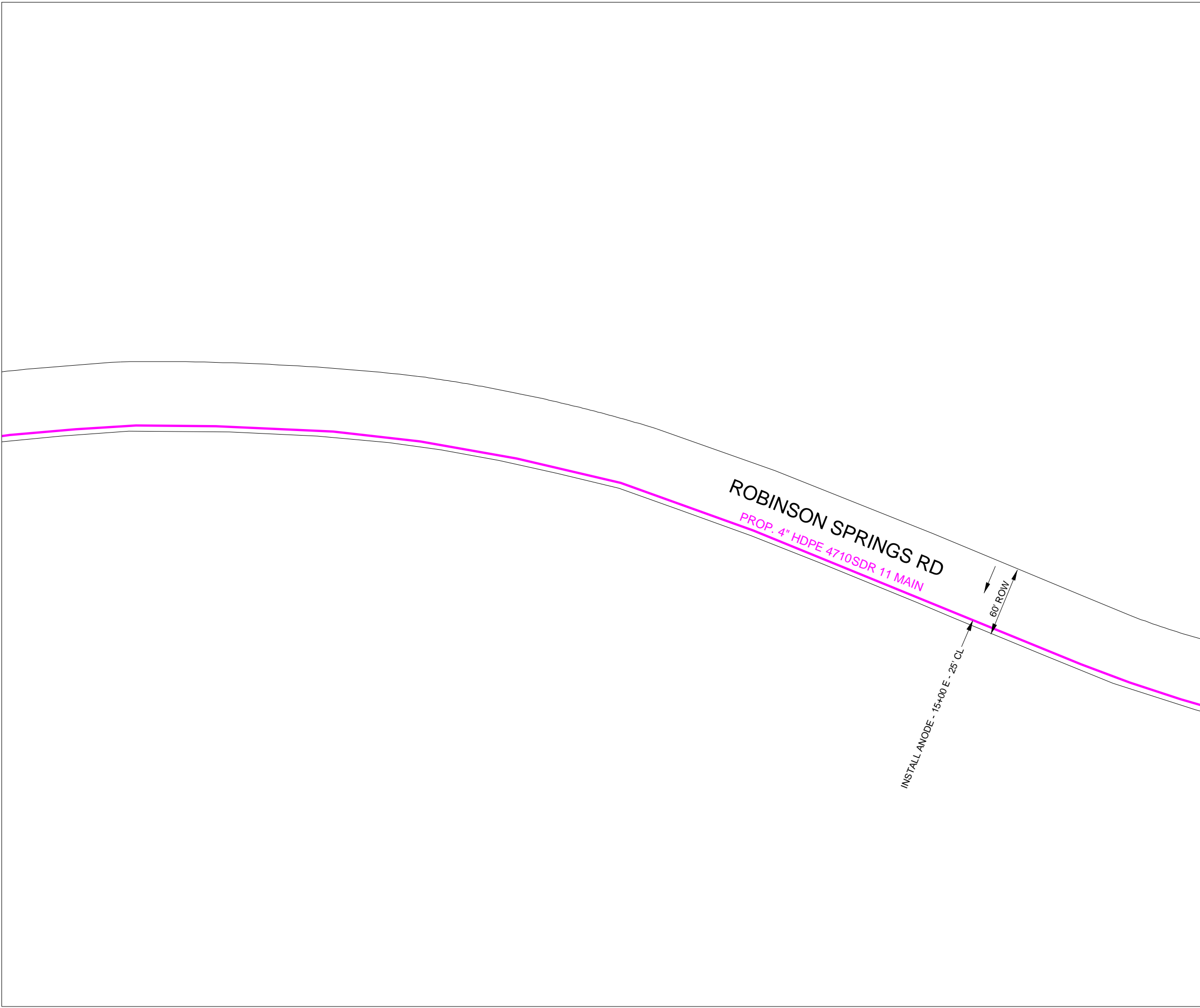

- NOTES:
- MAOP 60 PSIG.
  - MAIN TO BE INSTALLED AT **4 FT** MIN. COVER UNLESS OTHERWISE SPECIFIED.
  - TEST ALL MAIN AT 150 PSIG FOR 8 HOURS.
  - SEWER MAIN AND LATERALS MUST BE SPOTTED DURING INSTALLATION OF MAIN BY TRENCHLESS MEANS.
  - TRACER WIRE (#8) TO BE INSTALLED 6" ABOVE ALL HDPE GAS MAIN INSTALLED BY OPEN TRENCH.
  - TRACER WIRE (#8, ONE STRAND) TO BE INSTALLED WITH ALL HDPE MAIN INSTALLED BY TRENCHLESS MEANS.
  - PIPELINE WARNING TAPE TO BE INSTALLED AT 12" ABOVE ALL GAS MAIN INSTALLED BY OPEN TRENCH.
  - MARKER BALLS ARE TO BE INSTALLED AT ALL VALVES AND END OF MAIN LOCATIONS.



**GAS CONSTRUCTION PRINT**

PROJECT NO. 070.53923



SHEET 3 OF 11

PROJECT Stowers, John  
MANAGER \_\_\_\_\_

DATE 09/03/2024

100

PHONE \_\_\_\_\_

MAP # \_\_\_\_\_

© 2009 Atmos Energy

Maps, drawings and electronic data (products) are created for the internal purposes of Atmos Energy with no implication of suitability or fitness for the internal use of the recipient. Atmos Energy will make good faith efforts to provide products that are free from error, but does not warrant the accuracy or quality of such products. The locations shown are approximations and are not intended to show exact locations. Products provided to other parties by Atmos Energy are for the internal use of the recipient, and the recipient agrees not to duplicate or distribute the products or any portion of the products to third parties without the prior written permission of Atmos Energy. The recipient further agrees to hold harmless and indemnify Atmos Energy against all claims, costs, expenses and damages resulting from or predicated upon strict liability for personal injuries, death or property damage, on account of any defects in the property provided hereunder.

PROJECT NAME 070.5073.RG.4PE.ROBSPRING.PH2

CUSTOMER \_\_\_\_\_

ADDRESS \_\_\_\_\_

LOCATION MADISON, MS

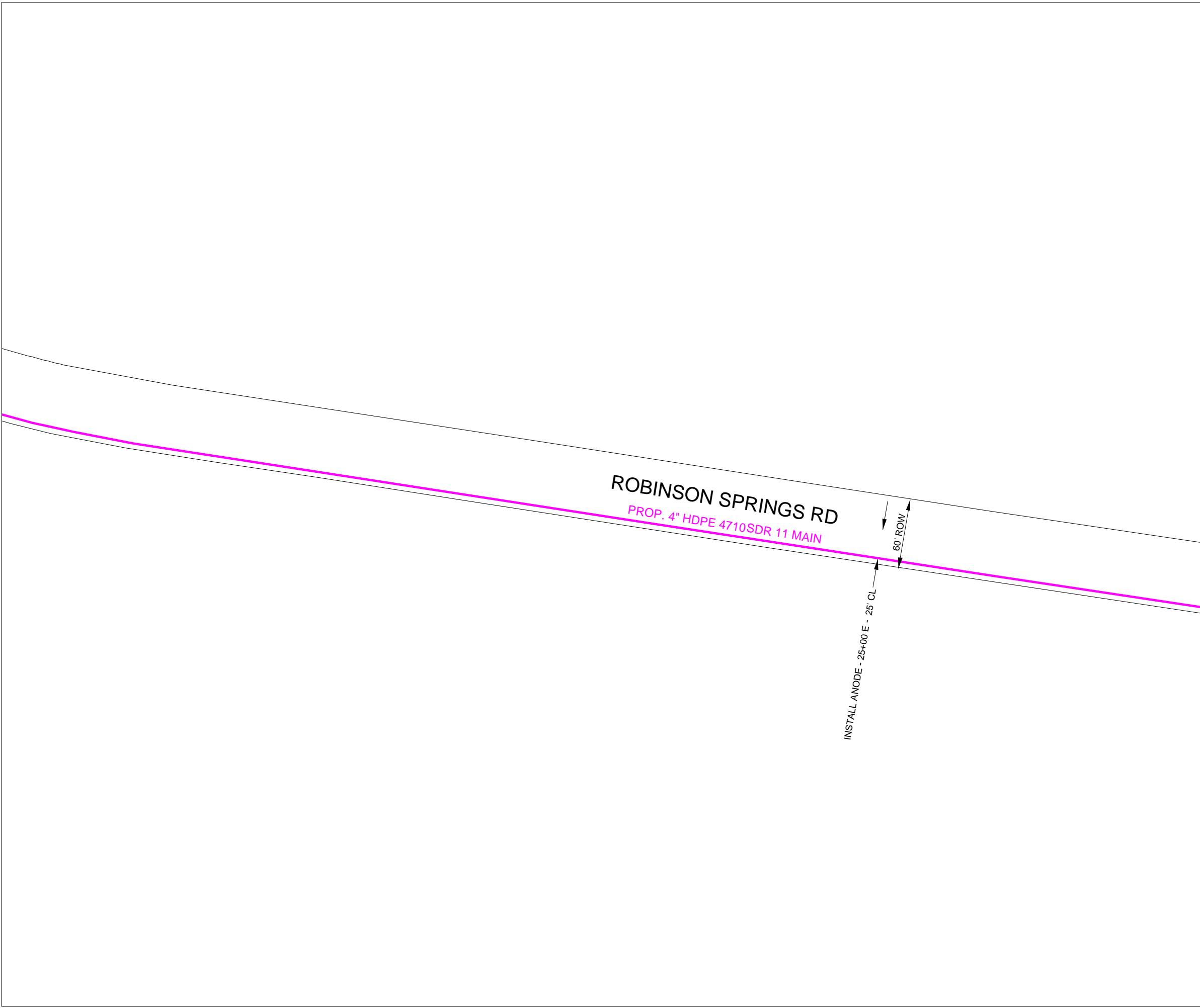

- NOTES:
- MAOP 60 PSIG.
  - MAIN TO BE INSTALLED AT **4 FT** MIN. COVER UNLESS OTHERWISE SPECIFIED.
  - TEST ALL MAIN AT 150 PSIG FOR 8 HOURS.
  - SEWER MAIN AND LATERALS MUST BE SPOTTED DURING INSTALLATION OF MAIN BY TRENCHLESS MEANS.
  - TRACER WIRE (#8) TO BE INSTALLED 6" ABOVE ALL HDPE GAS MAIN INSTALLED BY OPEN TRENCH.
  - TRACER WIRE (#8, ONE STRAND) TO BE INSTALLED WITH ALL HDPE MAIN INSTALLED BY TRENCHLESS MEANS.
  - PIPELINE WARNING TAPE TO BE INSTALLED AT 12" ABOVE ALL GAS MAIN INSTALLED BY OPEN TRENCH.
  - MARKER BALLS ARE TO BE INSTALLED AT ALL VALVES AND END OF MAIN LOCATIONS.



**GAS CONSTRUCTION PRINT**

PROJECT NO. 070.53923



SHEET 4 OF 11

PROJECT Stowers, John  
 MANAGER \_\_\_\_\_

DATE 09/03/2024

100

PHONE \_\_\_\_\_

MAP # \_\_\_\_\_

© 2009 Atmos Energy

Maps, drawings and electronic data (products) are created for the internal purposes of Atmos Energy with no implication of suitability or fitness for the internal use of the recipient. Atmos Energy will make good faith efforts to provide products that are free from error, but does not warrant the accuracy or quality of such products. The locations shown are approximations and are not intended to show exact locations. Products provided to other parties by Atmos Energy are for the internal use of the recipient, and the recipient agrees not to duplicate or distribute the products or any portion of the products to third parties without the prior written permission of Atmos Energy. The recipient further agrees to hold harmless and indemnify Atmos Energy against all claims, costs, expenses and damages resulting from or predicated upon strict liability for personal injuries, death or property damage, on account of any defects in the property provided hereunder.

PROJECT NAME 070.5073.RG.4PE.ROBSPRING.PH2

CUSTOMER \_\_\_\_\_

ADDRESS \_\_\_\_\_

LOCATION MADISON, MS

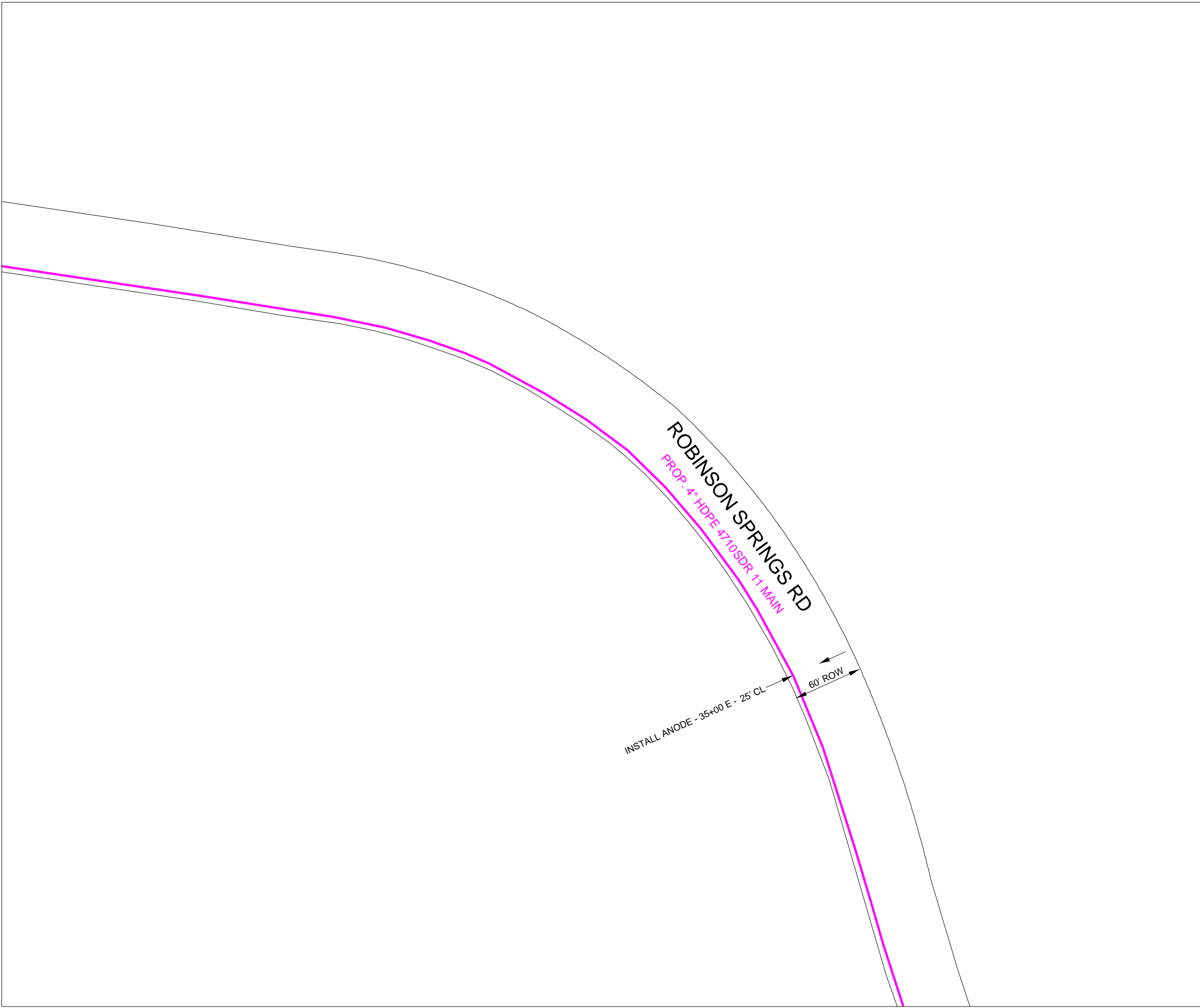

- NOTES:
- MAOP 60 PSIG.
  - MAIN TO BE INSTALLED AT **4 FT** MIN.
- COVER UNLESS OTHERWISE SPECIFIED.
- TEST ALL MAIN AT 150 PSIG FOR 8 HOURS.
  - SEWER MAIN AND LATERALS MUST BE SPOTTED DURING INSTALLATION OF MAIN BY TRENCHLESS MEANS.
  - TRACER WIRE (#8) TO BE INSTALLED 6" ABOVE ALL HDPE GAS MAIN INSTALLED BY OPEN TRENCH.
  - TRACER WIRE (#8, ONE STRAND) TO BE INSTALLED WITH ALL HDPE MAIN INSTALLED BY TRENCHLESS MEANS.
  - PIPELINE WARNING TAPE TO BE INSTALLED AT 12" ABOVE ALL GAS MAIN INSTALLED BY OPEN TRENCH.
  - MARKER BALLS ARE TO BE INSTALLED AT ALL VALVES AND END OF MAIN LOCATIONS.



**GAS CONSTRUCTION PRINT**

PROJECT NO. 070.53923



SHEET 5 OF 11

PROJECT Stowers, John  
MANAGER

DATE 09/03/2024

100

PHONE

MAP #

© 2009 Atmos Energy

Maps, drawings and electronic data (products) are created for the internal purposes of Atmos Energy with no implication of suitability or fitness for the internal use of the recipient. Atmos Energy will make good faith efforts to provide products that are free from error, but does not warrant the accuracy or quality of such products. The locations shown are approximations and are not intended to show exact locations. Products provided to other parties by Atmos Energy are for the internal use of the recipient, and the recipient agrees not to duplicate or distribute the products or any portion of the products to third parties without the prior written permission of Atmos Energy. The recipient further agrees to hold harmless and indemnify Atmos Energy against all claims, costs, expenses and damages resulting from or predicated upon strict liability for personal injuries, death or property damage, on account of any defects in the property provided hereunder.

PROJECT NAME 070.5073.RG.4PE.ROBSPRING.PH2

CUSTOMER

ADDRESS

LOCATION MADISON, MS



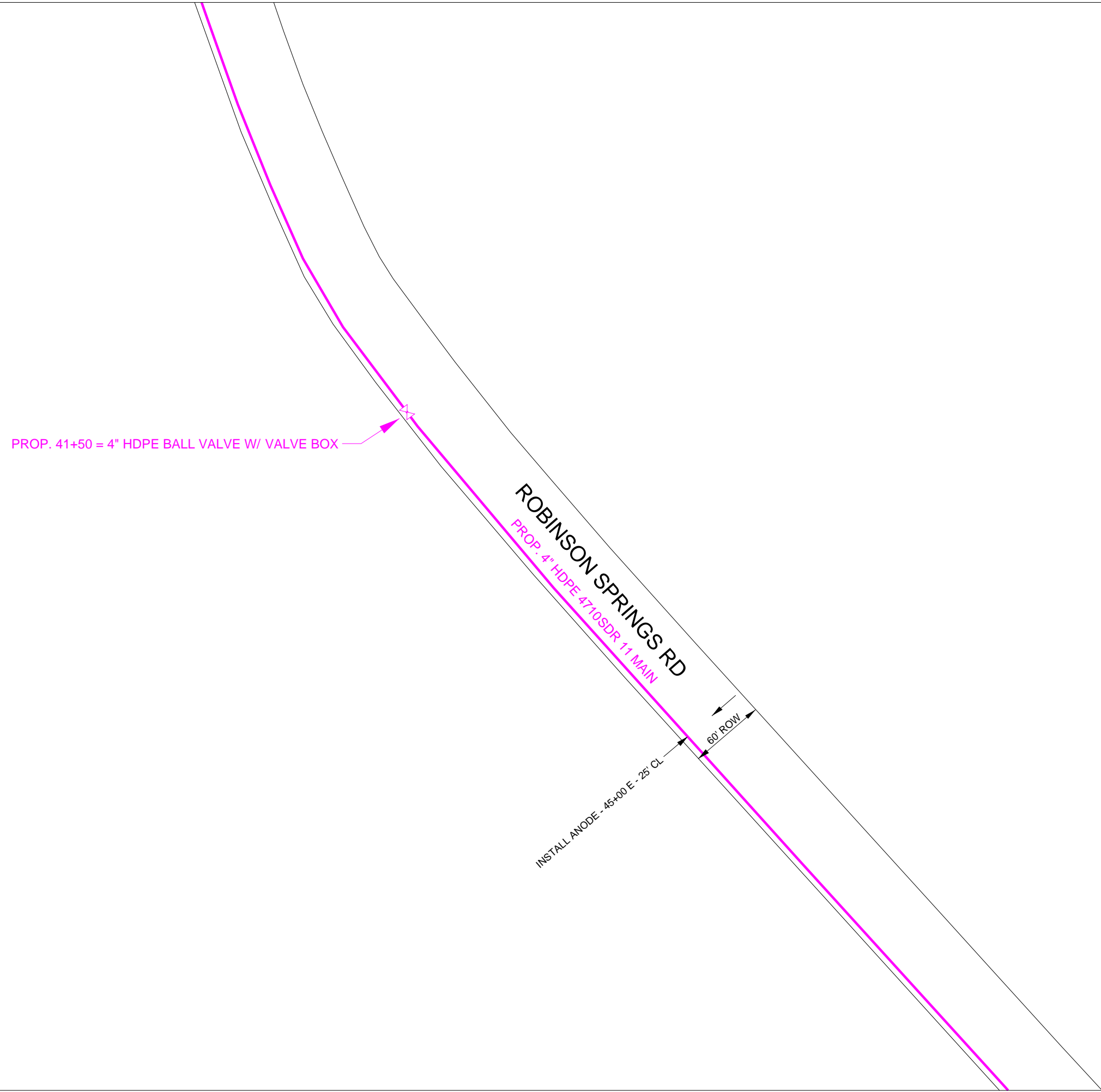

- NOTES:
- MAOP 60 PSIG.
  - MAIN TO BE INSTALLED AT **4 FT** MIN. COVER UNLESS OTHERWISE SPECIFIED.
  - TEST ALL MAIN AT 150 PSIG FOR 8 HOURS.
  - SEWER MAIN AND LATERALS MUST BE SPOTTED DURING INSTALLATION OF MAIN BY TRENCHLESS MEANS.
  - TRACER WIRE (#8) TO BE INSTALLED 6" ABOVE ALL HDPE GAS MAIN INSTALLED BY OPEN TRENCH.
  - TRACER WIRE (#8, ONE STRAND) TO BE INSTALLED WITH ALL HDPE MAIN INSTALLED BY TRENCHLESS MEANS.
  - PIPELINE WARNING TAPE TO BE INSTALLED AT 12" ABOVE ALL GAS MAIN INSTALLED BY OPEN TRENCH.
  - MARKER BALLS ARE TO BE INSTALLED AT ALL VALVES AND END OF MAIN LOCATIONS.



**GAS CONSTRUCTION PRINT**

PROJECT NO. 070.53923



SHEET 6 OF 11

PROJECT Stowers, John  
MANAGER

DATE 09/03/2024

100

PHONE

MAP #

© 2009 Atmos Energy

Maps, drawings and electronic data (products) are created for the internal purposes of Atmos Energy with an implication of suitability or fitness for the internal use of the recipient. Atmos Energy will make good faith efforts to provide products that are free from error, but does not warrant the accuracy or quality of such products. The locations shown are approximations and are not intended to show exact locations. Products provided to other parties by Atmos Energy are for the internal use of the recipient, and the recipient agrees not to duplicate or distribute the products or any portion of the products to third parties without the prior written permission of Atmos Energy. The recipient further agrees to hold harmless and indemnify Atmos Energy against all claims, costs, expenses and damages resulting from or predicated upon strict liability for personal injuries, death or property damage, on account of any defects in the property provided hereunder.

PROJECT NAME 070.5073.RG.4PE.ROBSPRING.PH2

CUSTOMER

ADDRESS

LOCATION MADISON, MS

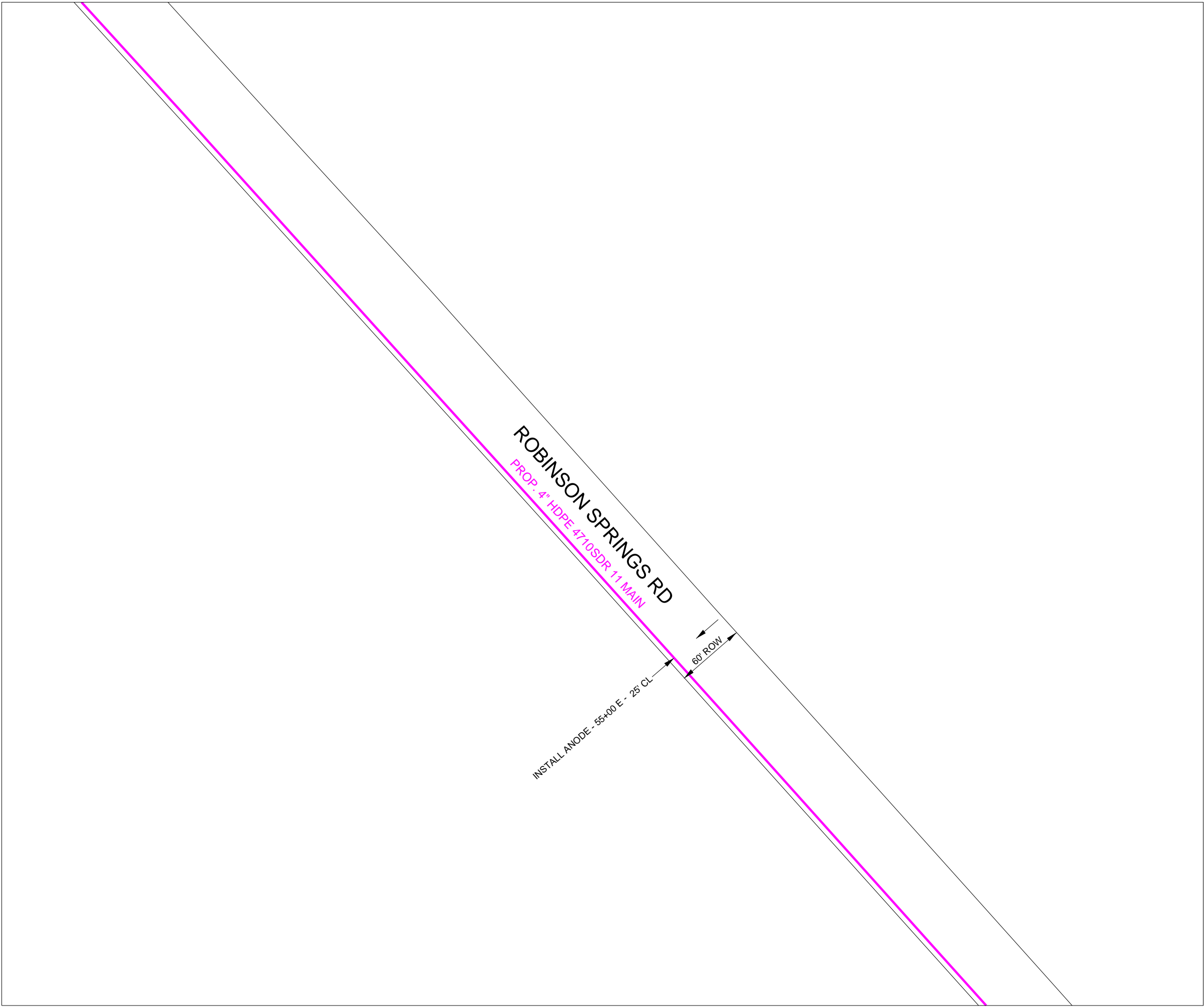

- NOTES:
- MAOP 60 PSIG.
  - MAIN TO BE INSTALLED AT **4 FT** MIN. COVER UNLESS OTHERWISE SPECIFIED.
  - TEST ALL MAIN AT 150 PSIG FOR 8 HOURS.
  - SEWER MAIN AND LATERALS MUST BE SPOTTED DURING INSTALLATION OF MAIN BY TRENCHLESS MEANS.
  - TRACER WIRE (#8) TO BE INSTALLED 6" ABOVE ALL HDPE GAS MAIN INSTALLED BY OPEN TRENCH.
  - TRACER WIRE (#8, ONE STRAND) TO BE INSTALLED WITH ALL HDPE MAIN INSTALLED BY TRENCHLESS MEANS.
  - PIPELINE WARNING TAPE TO BE INSTALLED AT 12" ABOVE ALL GAS MAIN INSTALLED BY OPEN TRENCH.
  - MARKER BALLS ARE TO BE INSTALLED AT ALL VALVES AND END OF MAIN LOCATIONS.

**GAS CONSTRUCTION PRINT**

PROJECT NO. 070.53923

SHEET 7 OF 11

DATE 09/03/2024

PROJECT Stowers, John

MANAGER \_\_\_\_\_ 100

PHONE \_\_\_\_\_ MAP # \_\_\_\_\_

© 2009 Atmos Energy

Maps, drawings and electronic data (products) are created for the internal purposes of Atmos Energy with an implication of suitability or fitness for the internal use of the recipient. Atmos Energy will make good faith efforts to provide products that are free from error, but does not warrant the accuracy or quality of such products. The locations shown are approximations and are not intended to show exact locations. Products provided to other parties by Atmos Energy are for the internal use of the recipient, and the recipient agrees not to duplicate or distribute the products or any portion of the products to third parties without the prior written permission of Atmos Energy. The recipient further agrees to hold harmless and indemnify Atmos Energy against all claims, costs, expenses and damages resulting from or predicated upon strict liability for personal injuries, death or property damage, on account of any defects in the property provided hereunder.

PROJECT NAME 070.5073.RG.4PE.ROBSPRING.PH2

CUSTOMER \_\_\_\_\_

ADDRESS \_\_\_\_\_

LOCATION MADISON, MS

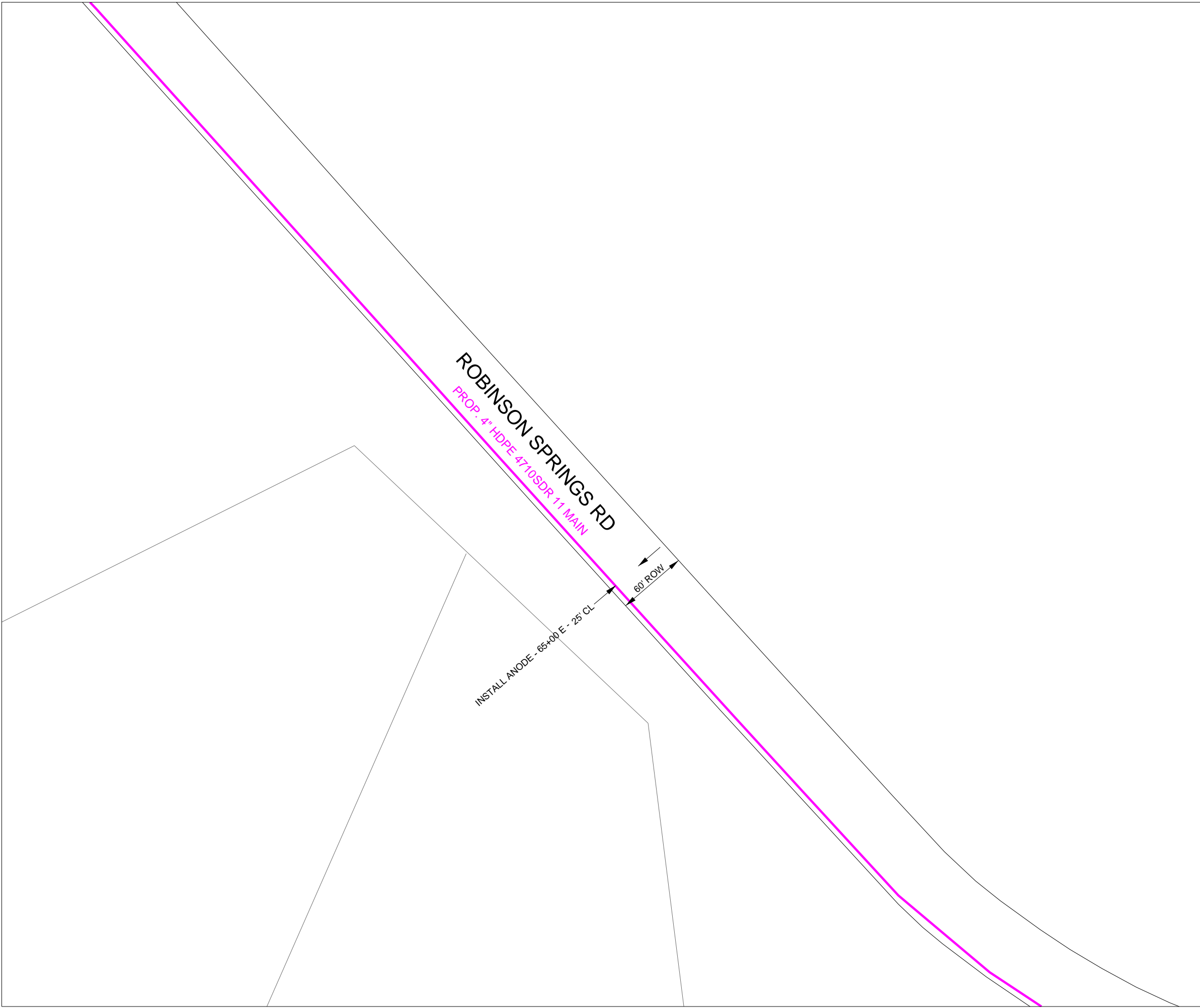

NOTES:

- MAOP 60 PSIG.
- MAIN TO BE INSTALLED AT **4 FT** MIN. COVER UNLESS OTHERWISE SPECIFIED.
- TEST ALL MAIN AT 150 PSIG FOR 8 HOURS.
- SEWER MAIN AND LATERALS MUST BE SPOTTED DURING INSTALLATION OF MAIN BY TRENCHLESS MEANS.
- TRACER WIRE (#8) TO BE INSTALLED 6" ABOVE ALL HDPE GAS MAIN INSTALLED BY OPEN TRENCH.
- TRACER WIRE (#8, ONE STRAND) TO BE INSTALLED WITH ALL HDPE MAIN INSTALLED BY TRENCHLESS MEANS.
- PIPELINE WARNING TAPE TO BE INSTALLED AT 12" ABOVE ALL GAS MAIN INSTALLED BY OPEN TRENCH.
- MARKER BALLS ARE TO BE INSTALLED AT ALL VALVES AND END OF MAIN LOCATIONS.



**GAS CONSTRUCTION PRINT**

PROJECT NO. 070.53923



SHEET 8 OF 11

PROJECT Stowers, John  
MANAGER \_\_\_\_\_

DATE 09/03/2024

PHONE \_\_\_\_\_

MAP # 100

© 2009 Atmos Energy

Maps, drawings and electronic data (products) are created for the internal purposes of Atmos Energy with no implication of suitability or fitness for the internal use of the recipient. Atmos Energy will make good faith efforts to provide products that are free from error, but does not warrant the accuracy or quality of such products. The locations shown are approximations and are not intended to show exact locations. Products provided to other parties by Atmos Energy are for the internal use of the recipient, and the recipient agrees not to duplicate or distribute the products or any portion of the products to third parties without the prior written permission of Atmos Energy. The recipient further agrees to hold harmless and indemnify Atmos Energy against all claims, costs, expenses and damages resulting from or predicated upon strict liability for personal injuries, death or property damage, on account of any defects in the property provided hereunder.

PROJECT NAME 070.5073.RG.4PE.ROBSPRING.PH2

CUSTOMER \_\_\_\_\_

ADDRESS \_\_\_\_\_

LOCATION MADISON, MS

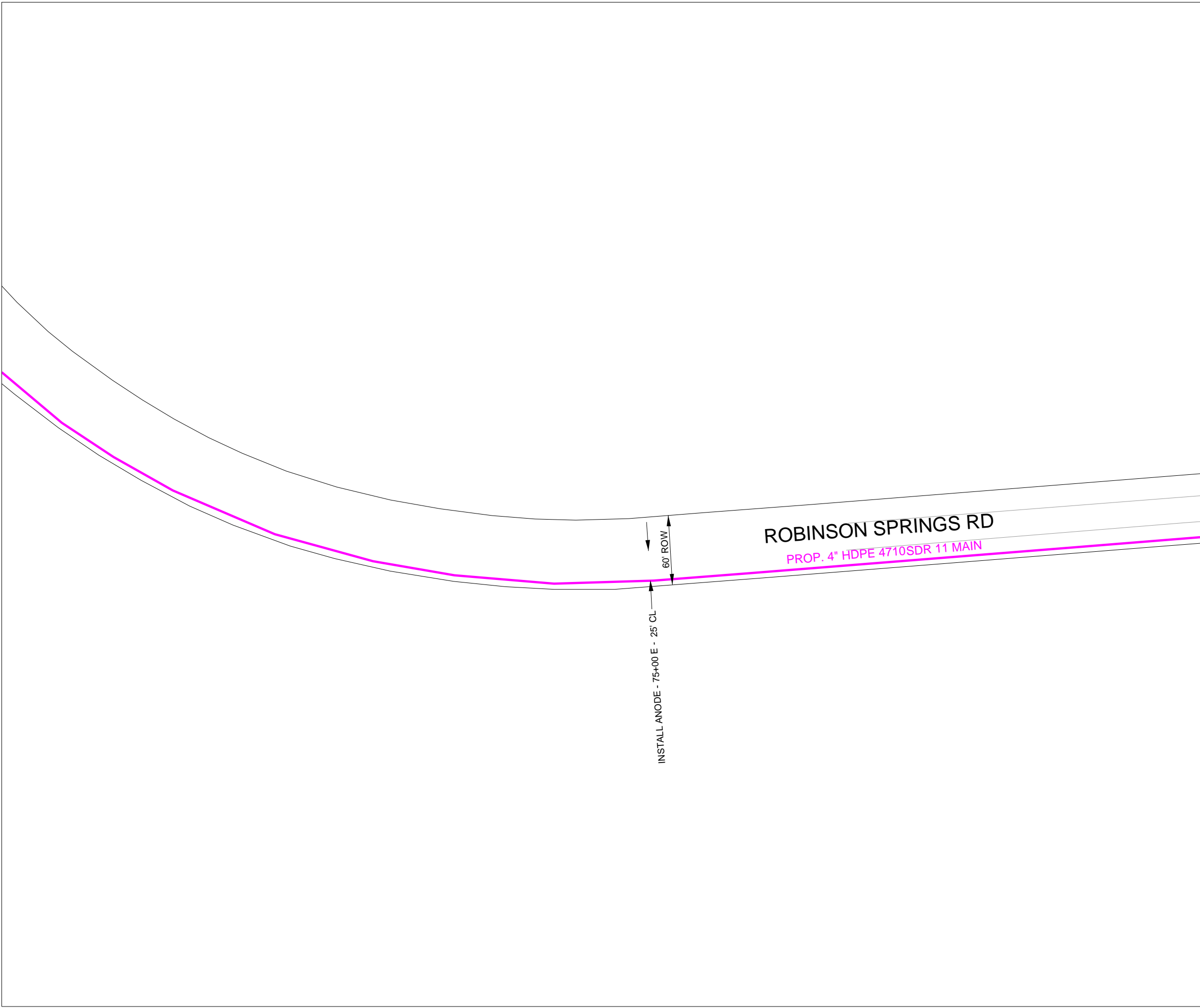

- NOTES:
- MAOP 60 PSIG.
  - MAIN TO BE INSTALLED AT **4 FT** MIN. COVER UNLESS OTHERWISE SPECIFIED.
  - TEST ALL MAIN AT 150 PSIG FOR 8 HOURS.
  - SEWER MAIN AND LATERALS MUST BE SPOTTED DURING INSTALLATION OF MAIN BY TRENCHLESS MEANS.
  - TRACER WIRE (#8) TO BE INSTALLED 6" ABOVE ALL HDPE GAS MAIN INSTALLED BY OPEN TRENCH.
  - TRACER WIRE (#8, ONE STRAND) TO BE INSTALLED WITH ALL HDPE MAIN INSTALLED BY TRENCHLESS MEANS.
  - PIPELINE WARNING TAPE TO BE INSTALLED AT 12" ABOVE ALL GAS MAIN INSTALLED BY OPEN TRENCH.
  - MARKER BALLS ARE TO BE INSTALLED AT ALL VALVES AND END OF MAIN LOCATIONS.



**GAS CONSTRUCTION PRINT**

PROJECT NO. 070.53923



SHEET 9 OF 11

PROJECT Stowers, John  
MANAGER

DATE 09/03/2024

PHONE \_\_\_\_\_

100

MAP # \_\_\_\_\_

© 2009 Atmos Energy

Maps, drawings and electronic data (products) are created for the internal purposes of Atmos Energy with no implication of suitability or fitness for the internal use of the recipient. Atmos Energy will make good faith efforts to provide products that are free from error, but does not warrant the accuracy or quality of such products. The locations shown are approximations and are not intended to show exact locations. Products provided to other parties by Atmos Energy are for the internal use of the recipient, and the recipient agrees not to duplicate or distribute the products or any portion of the products to third parties without the prior written permission of Atmos Energy. The recipient further agrees to hold harmless and indemnify Atmos Energy against all claims, costs, expenses and damages resulting from or predicated upon strict liability for personal injuries, death or property damage, on account of any defects in the property provided hereunder.

PROJECT NAME 070.5073.RG.4PE.ROBSPRING.PH2

CUSTOMER \_\_\_\_\_

ADDRESS \_\_\_\_\_

LOCATION MADISON, MS

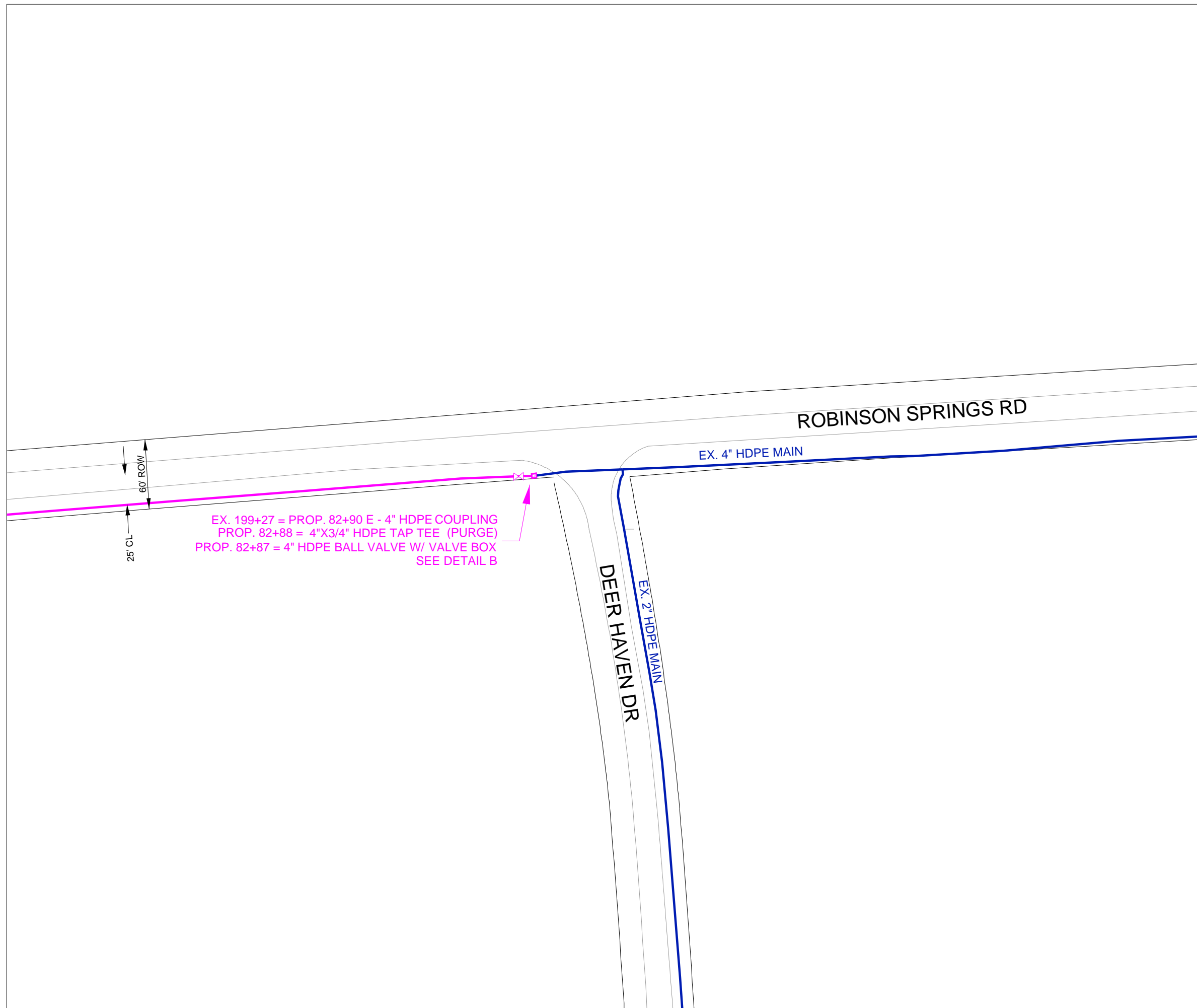

NOTES:

- MAOP 60 PSIG.
- MAIN TO BE INSTALLED AT **4 FT** MIN.
- COVER UNLESS OTHERWISE SPECIFIED.
- TEST ALL MAIN AT 150 PSIG FOR 8 HOURS.
- SEWER MAIN AND LATERALS MUST BE SPOTTED DURING INSTALLATION OF MAIN BY TRENCHLESS MEANS.
- TRACER WIRE (#8) TO BE INSTALLED 6" ABOVE ALL HDPE GAS MAIN INSTALLED BY OPEN TRENCH.
- TRACER WIRE (#8, ONE STRAND) TO BE INSTALLED WITH ALL HDPE MAIN INSTALLED BY TRENCHLESS MEANS.
- PIPELINE WARNING TAPE TO BE INSTALLED AT 12" ABOVE ALL GAS MAIN INSTALLED BY OPEN TRENCH.
- MARKER BALLS ARE TO BE INSTALLED AT ALL VALVES AND END OF MAIN LOCATIONS.



**GAS CONSTRUCTION PRINT**

PROJECT NO. 070.53923



SHEET 10 OF 11

PROJECT Stowers, John

DATE 09/03/2024

MANAGER

100

PHONE

MAP #

© 2009 Atmos Energy

Maps, drawings and electronic data (products) are created for the internal purposes of Atmos Energy with an implication of suitability or fitness for the internal use of the recipient. Atmos Energy will make good faith efforts to provide products that are free from error, but does not warrant the accuracy or quality of such products. The locations shown are approximations and are not intended to show exact locations. Products provided to other parties by Atmos Energy are for the internal use of the recipient, and the recipient agrees not to duplicate or distribute the products or any portion of the products to third parties without the prior written permission of Atmos Energy. The recipient further agrees to hold harmless and indemnify Atmos Energy against all claims, costs, expenses and damages resulting from or predicated upon strict liability for personal injuries, death or property damage, on account of any defects in the property provided hereunder.

PROJECT NAME 070.5073.RG.4PE.ROBSPRING.PH2

CUSTOMER

ADDRESS

LOCATION MADISON, MS

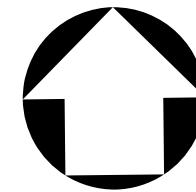

DETAIL "A"  
N.T.S

DETAIL "B"  
N.T.S



Know what's below.  
Call before you dig.

NOTES:

- MAOP 60 PSIG.
- MAIN TO BE INSTALLED AT **4 FT** MIN. COVER UNLESS OTHERWISE SPECIFIED.
- TEST ALL MAIN AT 150 PSIG FOR 8 HOURS.
- SEWER MAIN AND LATERALS MUST BE SPOTTED DURING INSTALLATION OF MAIN BY TRENCHLESS MEANS.
- TRACER WIRE (#8) TO BE INSTALLED 6" ABOVE ALL HDPE GAS MAIN INSTALLED BY OPEN TRENCH.
- TRACER WIRE (#8, ONE STRAND) TO BE INSTALLED WITH ALL HDPE MAIN INSTALLED BY TRENCHLESS MEANS.
- PIPELINE WARNING TAPE TO BE INSTALLED AT 12" ABOVE ALL GAS MAIN INSTALLED BY OPEN TRENCH.
- MARKER BALLS ARE TO BE INSTALLED AT ALL VALVES AND END OF MAIN LOCATIONS.

PROJECT #: 070.53923

MADISON: INSTALL 4" HDPE MAIN  
ROBINSON SPRINGS ROAD

MADISON, MADISON COUNTY, MISSISSIPPI  
ATMOS ENERGY CORPORATION

DRAWN BY: JAS	DATE: 09/03/2024	T.N. - N.A.
SCALE: AS SHOWN		SHEET 11 OF 11